

STANDARD BIKE LANES

NOTE:
1. SEE PAVE-900 FOR SYMBOL DETAILS.

NOT TO SCALE

APPROVED BY: _____ (SPECIAL DETAIL)
DIRECTOR, BUREAU OF FIELD SERVICES



APPROVED BY: _____ (SPECIAL DETAIL)
DIRECTOR, BUREAU OF DEVELOPMENT

DEPARTMENT DIRECTOR
BRADLEY C. WIEFERICH, PE

(SPECIAL DETAIL)
FHWA APPROVAL

(SPECIAL DETAIL)
PLAN DATE

STANDARD PLAN FOR
BIKE LANE & PATH
PAVEMENT MARKINGS

PAVE-962-C

SHEET
1 OF 6

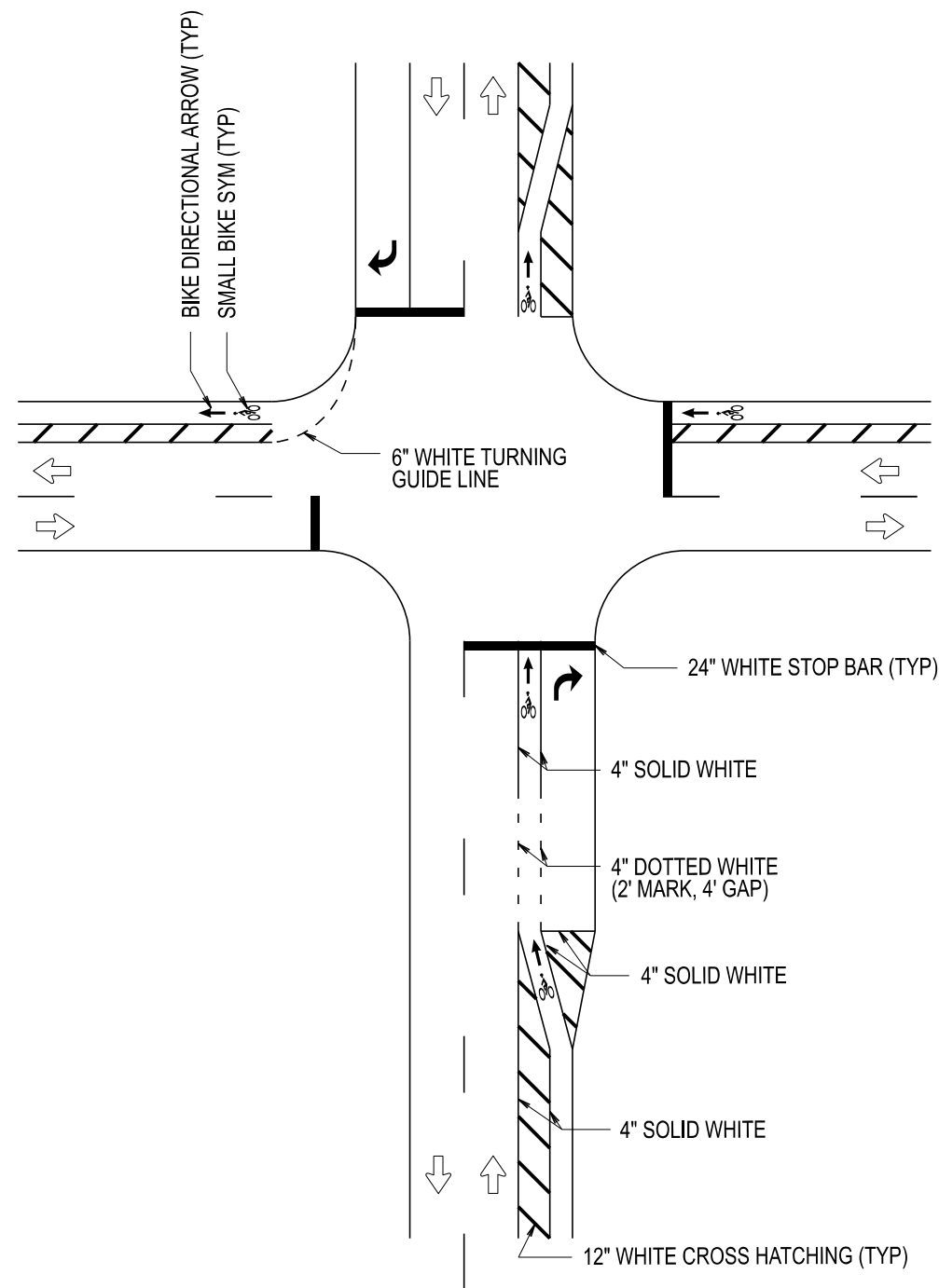

BUFFERED BIKE LANES

NOTE:
1. SEE PAVE-900 FOR SYMBOL DETAILS.

NOT TO SCALE



DEPARTMENT DIRECTOR
BRADLEY C. WIEFERICH, PE

(SPECIAL DETAIL)
FHWA APPROVAL

(SPECIAL DETAIL)
PLAN DATE

STANDARD PLAN FOR
BIKE LANE & PATH
PAVEMENT MARKINGS

PAVE-962-C

SHEET
2 OF 6

SECT

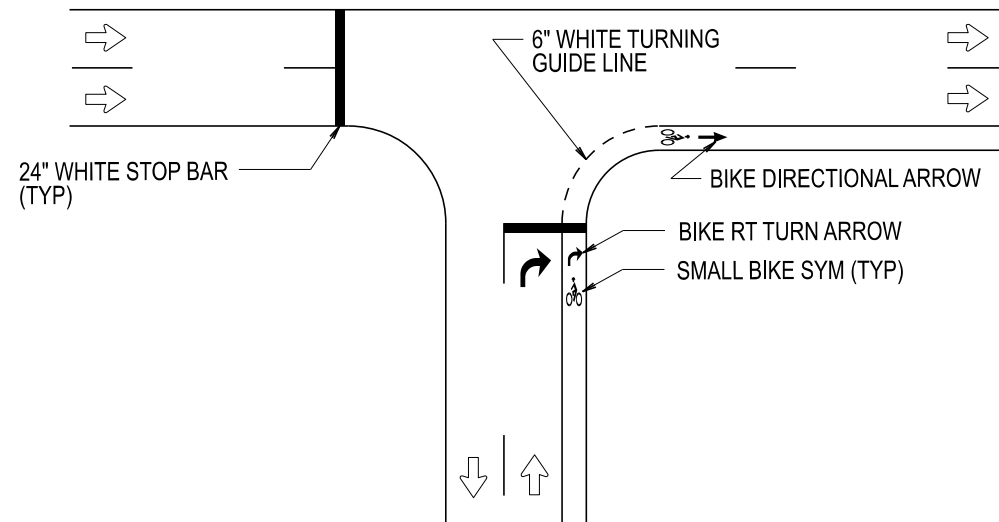
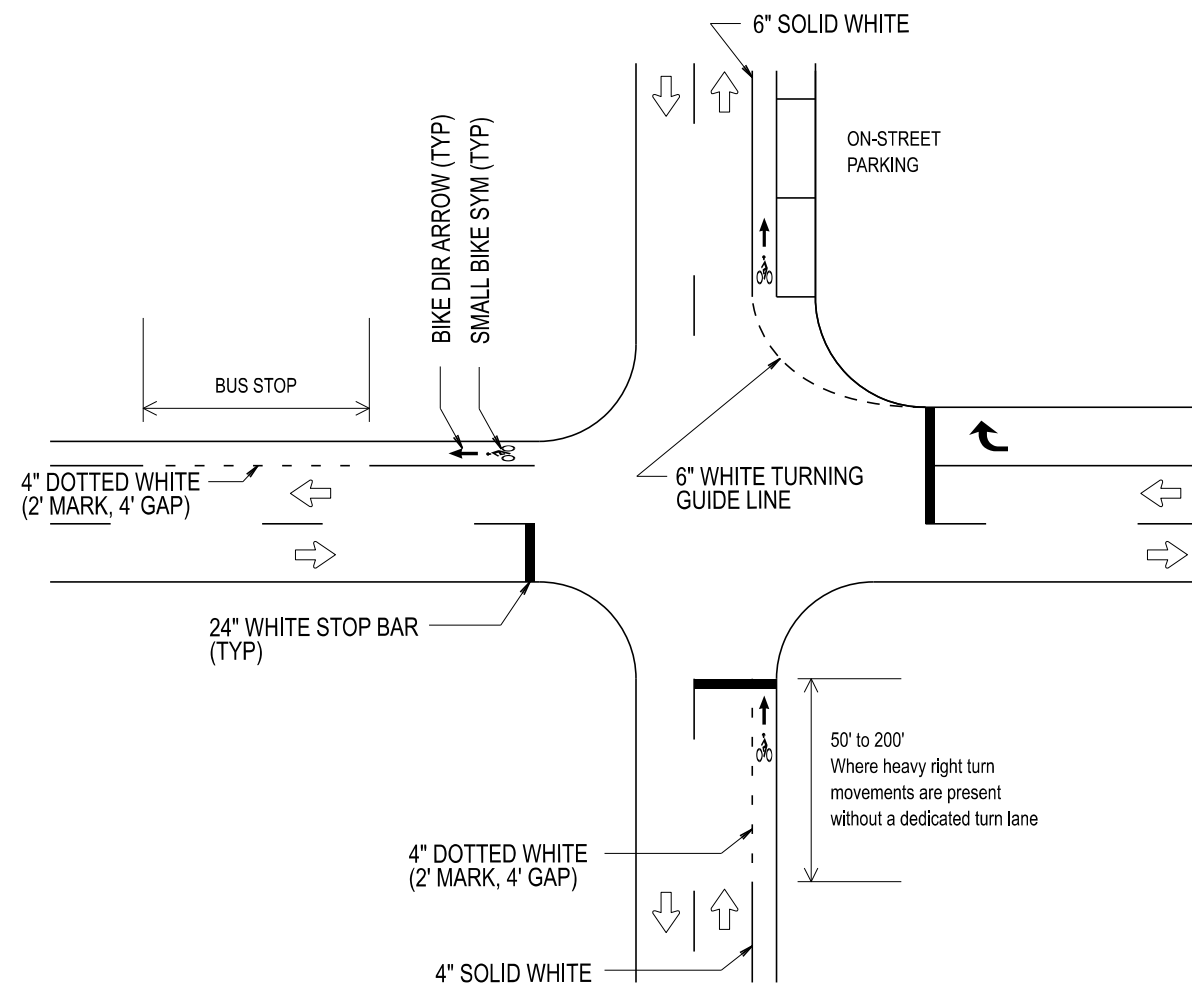

ADDITIONAL DETAILS

- NOTES:
 1. SEE PAVE-900 FOR SYMBOL DETAILS.
 2. WHERE BIKE LANES ARE ADJACENT TO ON-STREET PARKING, RECOMMEND UTILIZING TYPE I OR TYPE II STALL MARKINGS TO PROVIDE CONTINUOUS DELINEATION. SEE PAVE-955 FOR DETAILS.

	STANDARD PLAN FOR BIKE LANE & PATH PAVEMENT MARKINGS			SHEET 3 OF 6
	(SPECIAL DETAIL) FHWA APPROVAL	(SPECIAL DETAIL) PLAN DATE	PAVE-962-C	

NOT TO SCALE

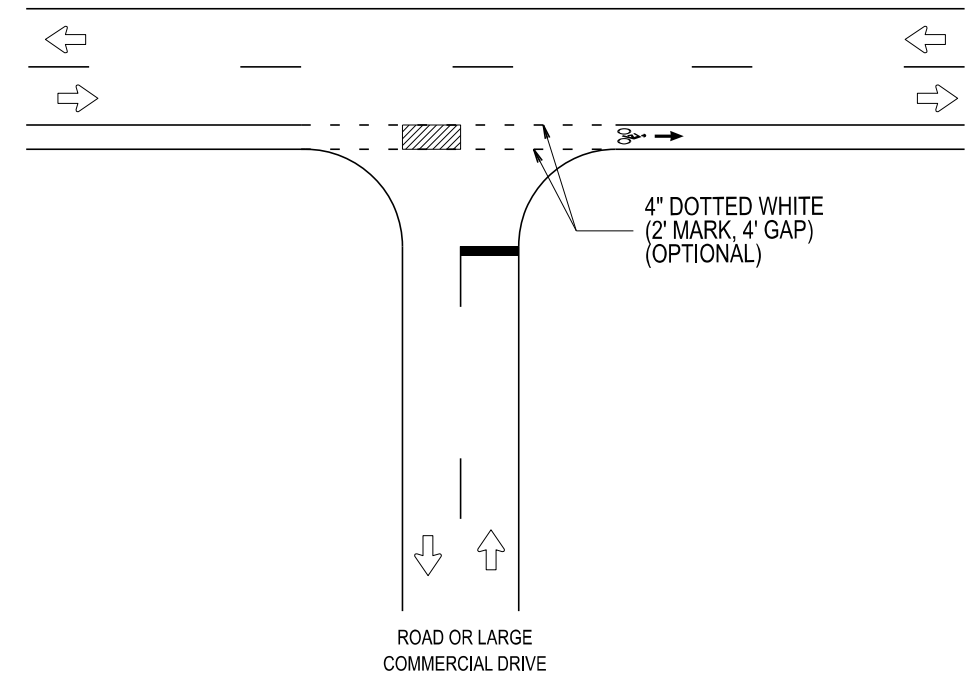
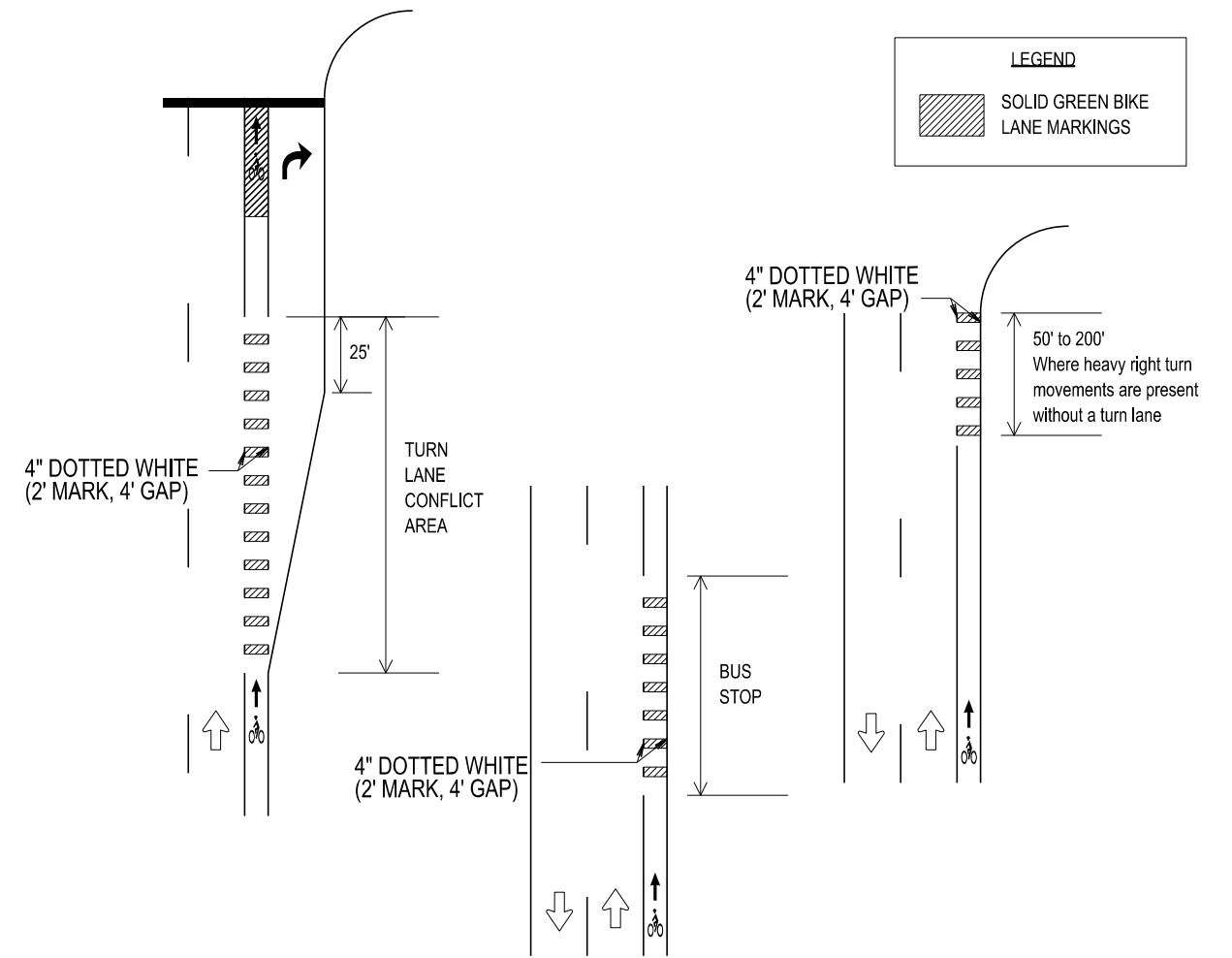

OPTIONAL GREEN MARKINGS

	STANDARD PLAN FOR BIKE LANE & PATH PAVEMENT MARKINGS			SHEET 4 OF 6
	(SPECIAL DETAIL) FHWA APPROVAL	(SPECIAL DETAIL) PLAN DATE	PAVE-962-C	

NOT TO SCALE

SECT

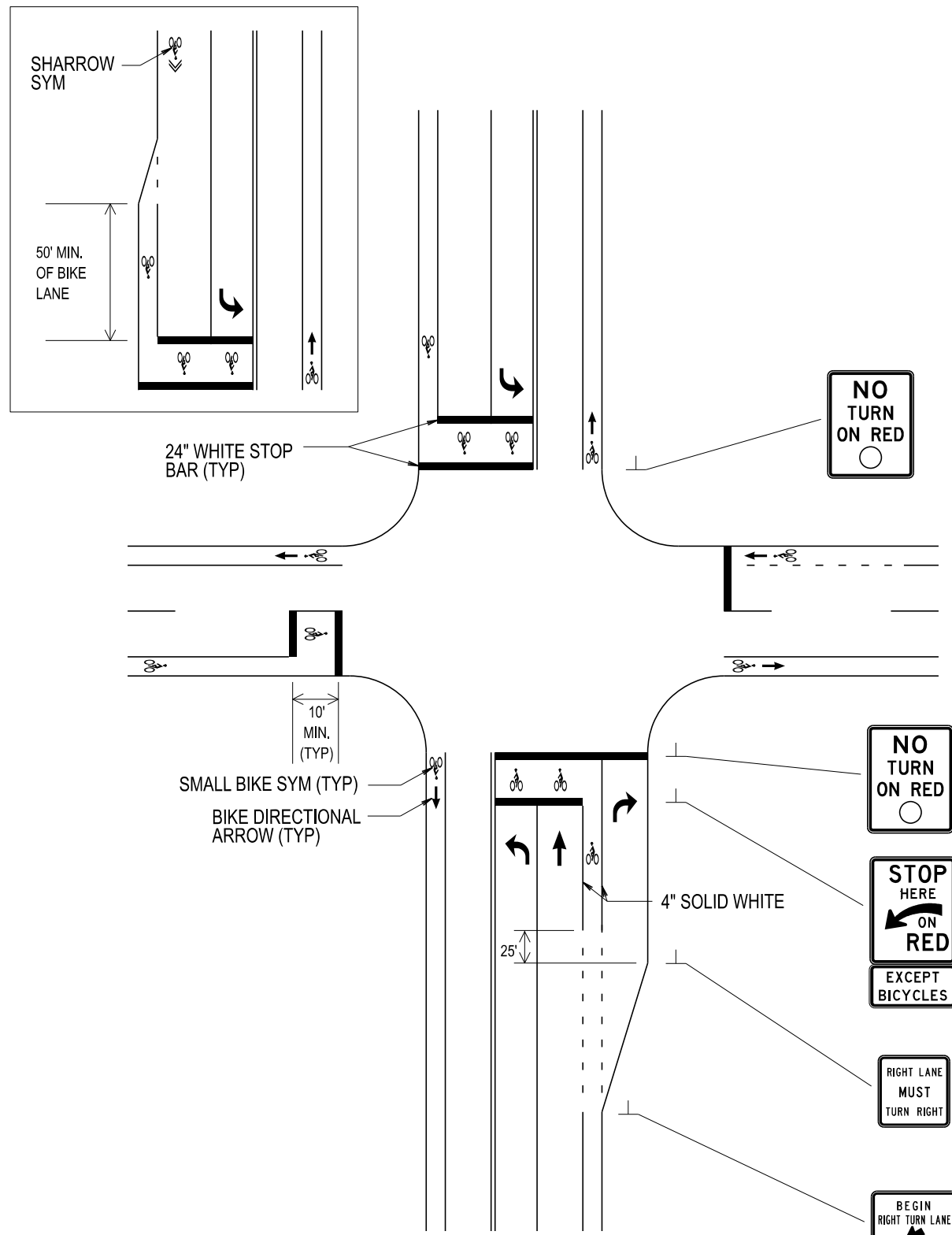

BIKE BOXES

- NOTES:
1. SOLID GREEN BIKE LANE MARKINGS MAY BE USED IN THE BIKE BOX AND THE INCOMING SECTION OF BIKE LANE.
 2. WHERE THE BIKE BOX IS ACROSS MULTIPLE LANES, PEDESTRIAN COUNTDOWN SIGNALS MUST BE PRESENT ON THAT APPROACH.
 3. TURNS ON RED ARE PROHIBITED FROM APPROACHES WHERE BIKE BOXES ARE PRESENT.

	STANDARD PLAN FOR BIKE LANE & PATH PAVEMENT MARKINGS			SHEET 5 OF 6
	(SPECIAL DETAIL) FHWA APPROVAL	(SPECIAL DETAIL) PLAN DATE	PAVE-962-C	

NOT TO SCALE

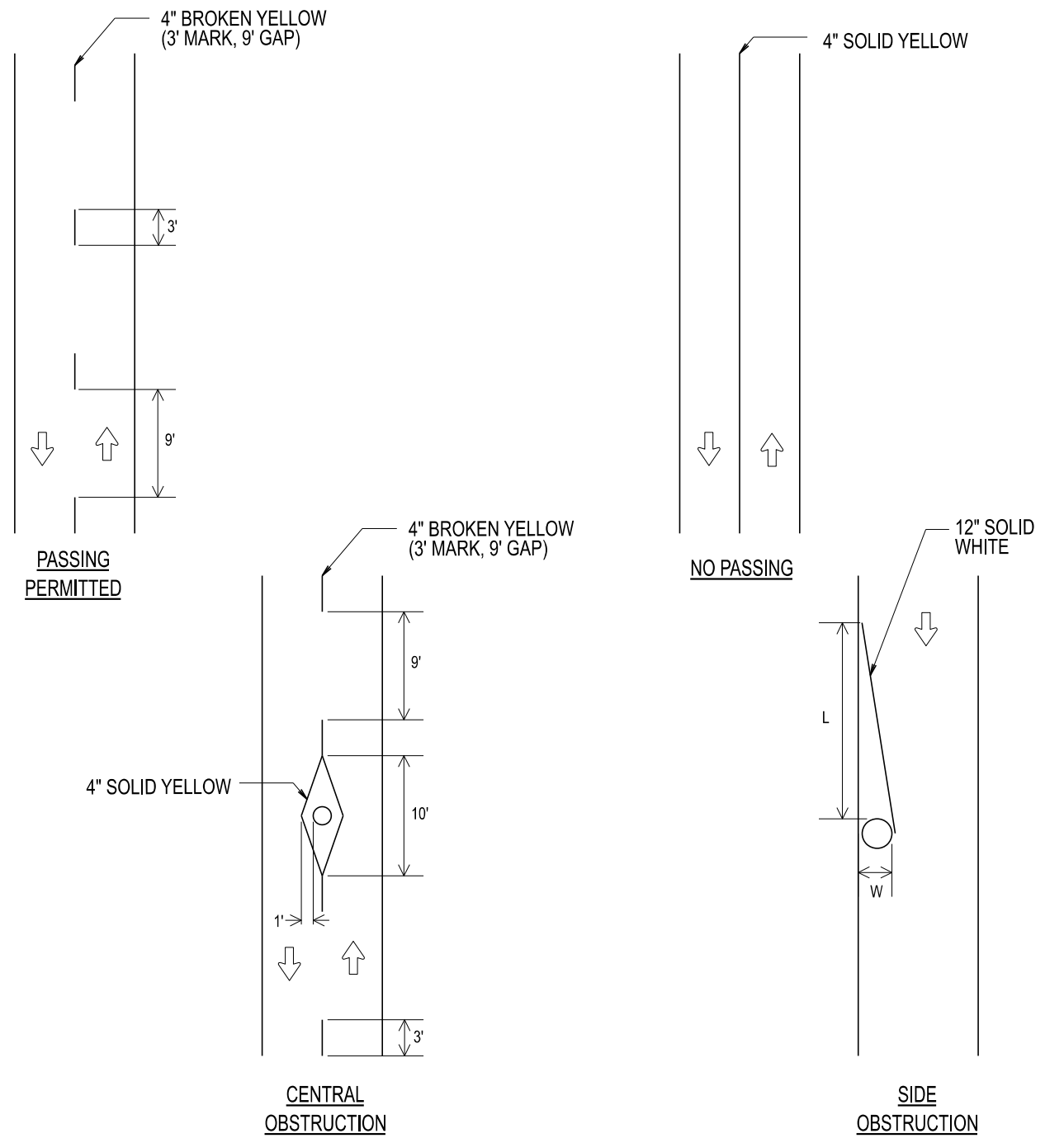

MULTI-USE PATHWAY MARKINGS

- NOTES:
1. PASSING AND NO PASSING CENTERLINE MARKINGS MAY BE USED WHERE PATHS ARE SUFFICIENT WIDTH TO DESIGNATE MULTIPLE LANES, BUT ARE NOT REQUIRED.
 2. OBSTRUCTION MARKINGS SHOULD BE USED AT ANY LOCATION WHERE AN OBJECT CANNOT BE ELIMINATED FROM THE PATH, INCLUDING BUT NOT LIMITED TO DRAINS, GRATES, BOLLARDS, AND POLES.

1. PLACE BROKEN YELLOW CENTERLINE MARKINGS FOR A MINIMUM OF 110 FEET BEFORE AND AFTER THE OBSTRUCTION.

1. $L=18XW$.
2. INCREASE W BY 1 FOOT FOR RAISED OBSTRUCTIONS.

	STANDARD PLAN FOR BIKE LANE & PATH PAVEMENT MARKINGS			SHEET 6 OF 6
	(SPECIAL DETAIL) FHWA APPROVAL	(SPECIAL DETAIL) PLAN DATE	PAVE-962-C	

NOT TO SCALE

SECT